

2

1

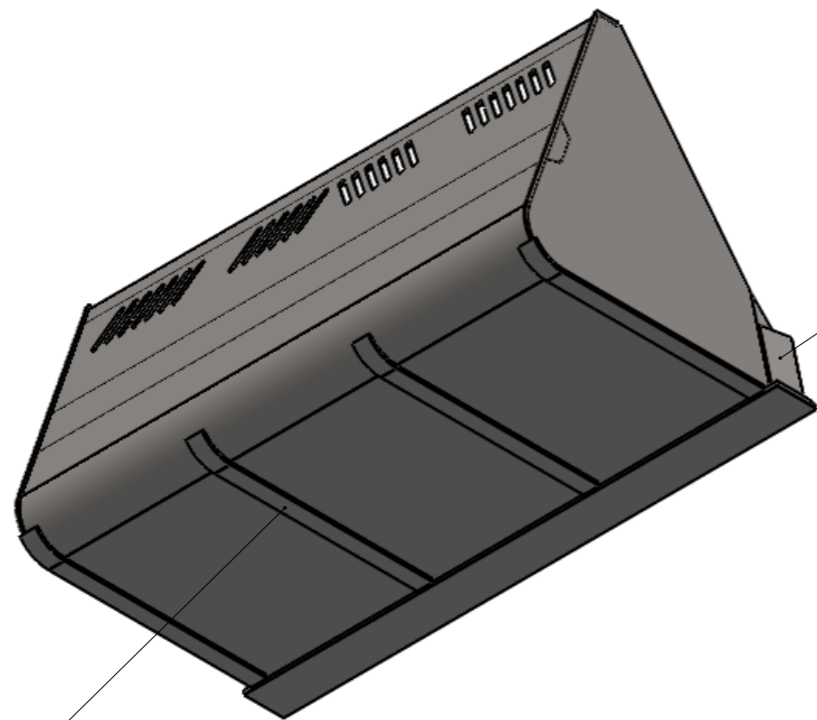

4

3

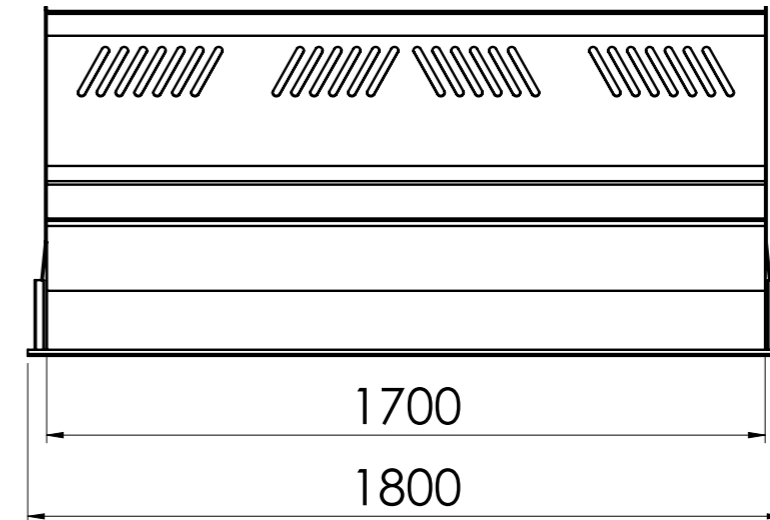
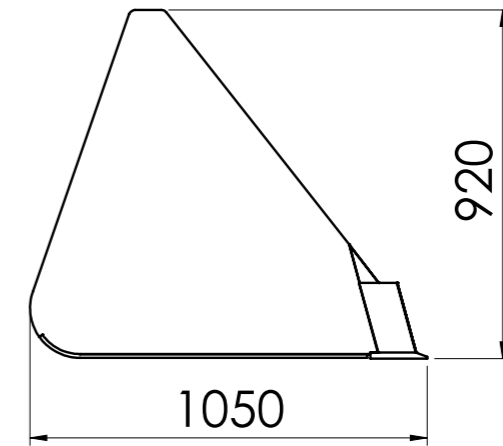

| 4   | Bottom bar   | S355     | 10 mm            |
|-----|--------------|----------|------------------|
| 3   | Side member  | HB 500   | 101x21/11x610 mm |
| 2   | Bottom plate | S355     | 4 mm             |
| 1   | Front edge   | HB 500   | 16x150x1800      |
| NO. | TITLE        | MATERIAL | DESCRIPTION      |

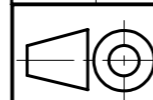

Volume 1060 L

Mass 215 kg

Scale

Drawn Teet Toming

Name

Checked

LMB490/1800

Approved

**PTC**

Sheet  
1 of 1

Date  
27.04.2015